

i-Tech Services
**FEATURED
PRODUCT**
MONTHLY | ISSUE 4

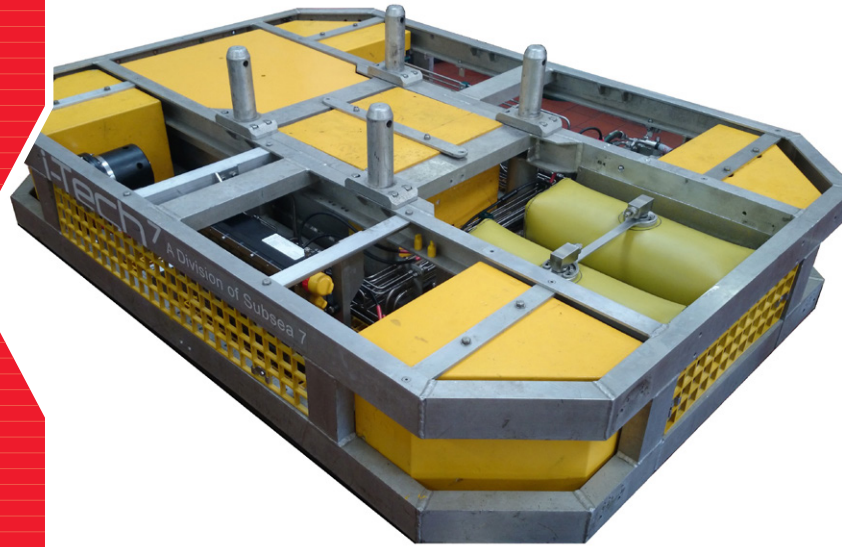

INTERVENTION CONTROL SKID

Your Swiss Army knife for subsea intervention. Shaped by over 10 years of development the Intervention Control Skid is practical and adaptable. The multi-purpose tool can be used to remotely operate subsea tooling, testing, fluid injection and installing Christmas trees.

Read about how we do it, *overleaf*.

We're a global provider of integrated engineering services and products throughout the oil and gas field life cycle. We focus on what matters most to you: reducing complexity, improving performance and lowering costs. We're all about using innovation and technology to unlock value.

INTERVENTION CONTROL SKID

The Intervention Control Skid is an extremely versatile product designed to carry out a variety of control and test functions. From the remote operation of subsea tooling, to Christmas tree installation, the skid is your Swiss Army knife for subsea intervention work scopes. The current version of this product is the third generation of a family of products which has evolved over the past 10 years, with multiple improvements being added at each stage. The latest version of the skid has been operating with great success in West Africa for the past three years.

Operated remotely from the surface with a standard laptop computer, the Intervention Control Skid can be quickly and easily configured to run on most work class ROV systems. Requirements from the ROV are minimal, and consist of a 30 litre per minute hydraulic supply, a 115 volt power connection and a data connection which can be either RS232 or RS485.

The unit has an on-board control system capable of operating a Torque Tool and Flying Lead Orientation Tool (FLOT) when fitted, in addition to the in-built auxiliary fluid pump which serves three A&B control line outputs and a 10k psi Intensifier test outlet.

When not required for Torque Tool operations, the FLOT can be removed, allowing the built-in tooling basket on the skid to be used, providing useful storage for ancillary tooling and other items and allowing the ROV to carry out multiple tasks without the need to interrupt operations to go and collect equipment.

The Auxiliary fluid system is fed by a 60 litre self-contained reservoir system within the skid, which can be filled with most types of water based or oil based control fluids.

The bespoke control system graphics allow for monitoring and recording of pressure and flow readings of the control and test outputs. Controls can easily be reconfigured to meet task specific requirements and configurations easily created, by dedicated support personnel, at very short notice to support ongoing operations.

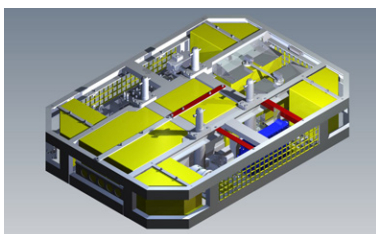

Want to know more about our Intervention Control Skid?

Contact: itechservices.clientenquiry@subsea7.com

www.i-tech7.com

i-Tech Services is a Subsea 7 company

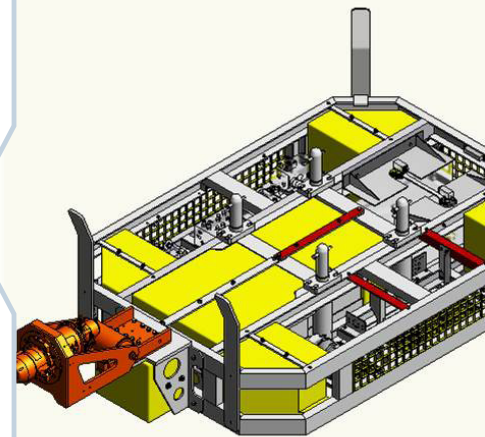

- Improves performance and lowers costs
- Carry out multiple control and test tasks on a single dive
- No need to transit to a subsea basket or recover to deck to re-tool
- Compatible with industry standard work class ROVs
- Capable of operating Torque Tools and Flying Lead Orientation Tools
- Integrated basket for storage for multiple tools, reduce number of trips to surface for re-tooling
- Simple data display provides real time accurate pressure and flow measurements to support testing tasks.